

# ARCHLINE

By Uniline

Archline is a new spring arm awning system developed and manufactured by Uniline Australia Ltd. The basic system is currently available, with the Sliding Lock Foot available from the end of August 2011.

The Archline awning allows the customer to maintain all day shade, with natural light and ventilation, all whilst maintaining privacy. Its versatility allows it to be developed to suit most window sizes and extends to various levels of projection depending on the customer's needs.

This system is offered in two options depending on the application, Standard or Plus. Both systems are available with either a standard fixed spring arm or an adjustable slide lock foot, depending on the available space and the projection required. Also available with the choice of a UV stabilised glass filled Nylon or grey powder coated cast aluminium Universal Clamp. Slide lock extrusions are available in a clear anodized finish and 5.8m lengths, minimising waste during manufacture.

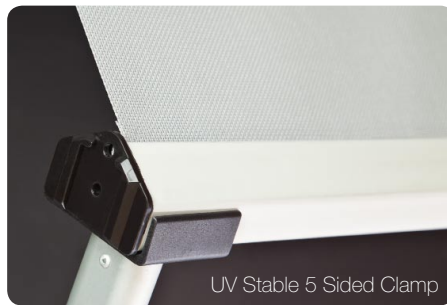

## Spring Arm Standard

- The Archline Standard caters for windows up to 3000mm wide, and can project out to 1200mm.
- The powder coated cast aluminium body and 2.5mm diameter spring with a stainless steel cable enable this awning to withstand the demands of the outside elements.
- In addition to this, another feature of the Archline system is a choice of operating controls; a crank gear box, a winch control box or, alternatively, a tubular motor.
- The spring unit is pre-assembled ready for the manufacturer to simply insert into the anodised aluminium extruded arm profile.
- The Archline Standard system utilises the five-sided awning tube as the front rail by using a UV stable nylon or cast aluminium clamp that slides into the arm profile and is then riveted into place to secure the components.



## Spring Arm Plus

- The Archline Plus extends the range by offering a heavy duty spring arm option.
- This option has all the features of the standard system, plus offers a 3.2mm diameter spring with a stainless steel cable. This spring arm provides a better choice for those customers who need to accommodate their larger windows or patio/veranda applications.
- Using either the sliding arm or lock, the Archline Plus can reach up to a span of 3500mm wide and a projection of 1500mm, using two arms.
- The Archline Spring Arm extrusion is common to both the Standard and the Plus system, requiring the manufacturer to only stock one common extrusion.
- The customer is given peace of mind as all the aluminium extrusions are manufactured with a anodised finish so the parts are protected from the elements and will not corrode, maintaining its quality appearance for many years to come.

# ARCHLINE

## MAXIMUM PROJECTION

## MAXIMUM WIDTH

	MAXIMUM PROJECTION	MAXIMUM WIDTH
STANDARD	1200mm	3000mm
PLUS	1500mm	3500mm

### ARCHLINE Diagram

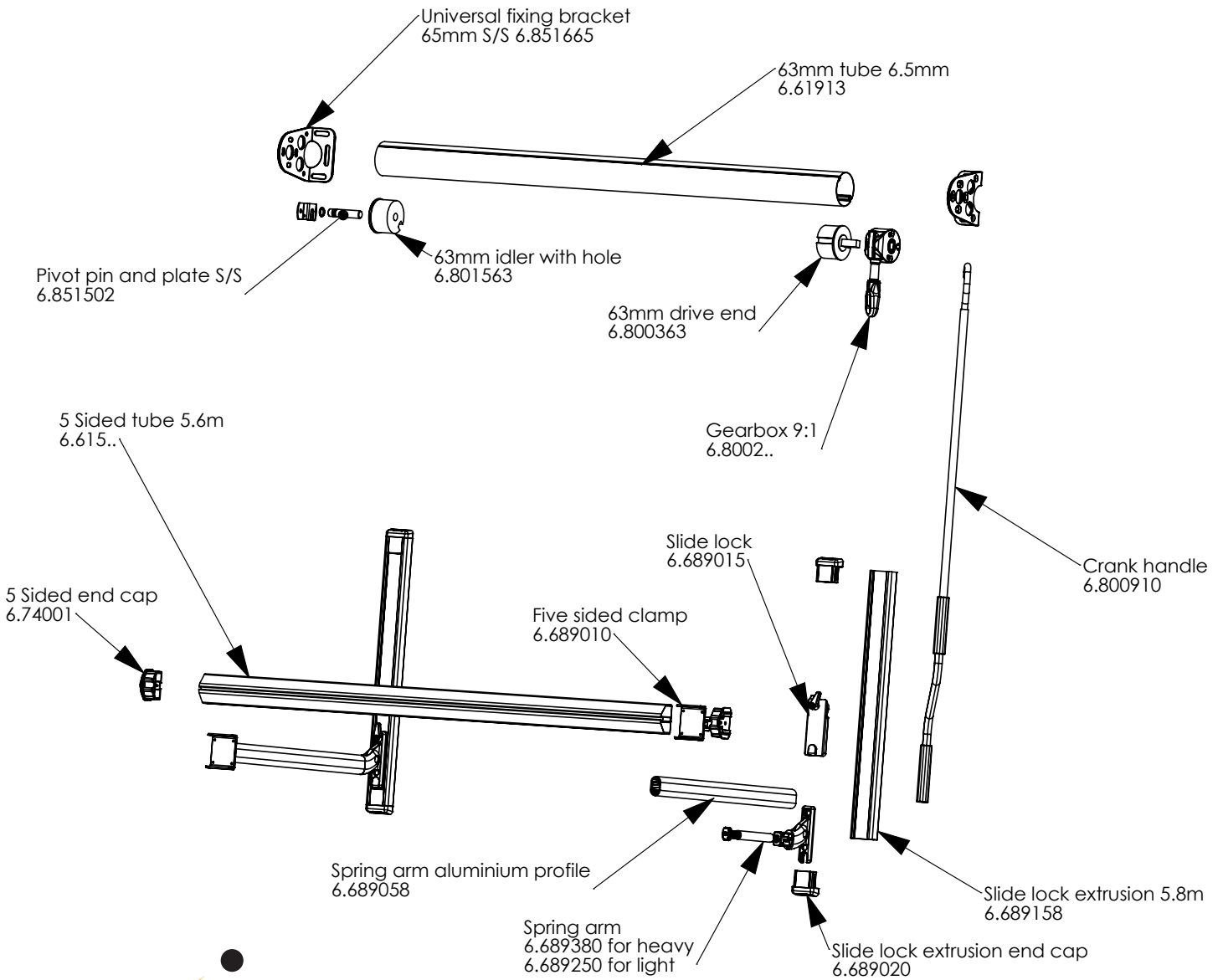

Uniline Australia Head Office: 2 Computer Road, Yatala, QLD, 4207  
 T: (07) 3804 9000 F: (07) 3804 9099 E: sales@uniline.com.au W: www.uniline.com.au

